

We wish to convey the history of "Kure" which made the Battleship Yamato, the importance of peace and the splendor of Science and technology to the future.

Once Kure flourished as the greatest naval port city in the East, as well as the greatest naval arsenal in Japan, which built the most powerful battleship YAMATO. After the war, Kure built many of the world's largest tankers by merging technology which had been developed since prewar periods and new technology, and played a role in developing Japan into the world's greatest shipbuilding country in about ten years from the end of the war. Since then, Kure has developed as one of the greatest waterfront industrial cities, and has contributed not only to regional industry development but also to the modernization of Japan. The "History of Kure" is the very history of the modernization of Japan since the Meiji Period.

Kure Maritime Museum, "Yamato Museum" introduces the "History of Kure" and a broad range of "Science and Technologies" including shipbuilding and steelmaking which have served as a foundation for the modernization of Japan, with a perspective on the efforts of our predecessors and lifestyles and cultures at that time.

In addition, this Museum aims to contribute significantly to education, culture and tourism in this area as "Kure's Unique Museum" which builds dreams and hopes for the future not only by educating people and having them acknowledge the history of Modern Japan and the importance of peace but also by having children, who forge the future of Japan, understand the splendor of science and technology.



STAMP

MEMO

Museum Hours

- 9:00 - 18:00 (Exhibition Rooms entrance permitted until 17:30)
- Library: 9:00 - 17:00

Museum Closed

Tuesdays (If Tuesday is a holiday, the Museum will be closed on the following day.)  
Open everyday between April 29 and May 5, between July 21 and August 31, and between December 29 and January 3.

Admission Fee

	Individual Fee	Group Fee (20 or more people)
Adults (Includes college students)	¥ 600	¥ 400
High School Students	¥ 300	¥ 200
Elementary & Jr. High Students	¥ 200	¥ 100

Access

- JR / Approximately 32 minutes from JR Hiroshima Station by JR Kure Line Rapid Liner, and approximately a 5 minute walk from JR Kure Station
- Car / Approximately 20 minutes by Hiroshima Kure Road (Kurea Line) from the direction of Hiroshima, and approximately 5 minutes from Kure Interchange
  - Approximately 30 minutes by Hiroshima Expressway - Hiroshima Kure Road from Sanyo Expressway (Hiroshima-Higashi JCT), and approximately 5 minutes from Kure Interchange
  - Approximately 40 minutes on Higashihiroshima-Kure Expressway from Sanyo Expressway (Takaya JCT)
  - Yamato Museum Parking Lot, capacity: 65 cars (¥ 100 per hour)
  - Yamato Museum Multi-Story Parking Lot, capacity: 220 cars (¥ 100 per hour)
- Bus / Approximately 46 minutes from Hiroshima Bus Center to the front of JR Kure Station, and approximately a 5 minute walk from JR Kure Station
  - Approximately 60 minutes from Hiroshima Airport to the front of JR Kure Station, and approximately a 5 minute walk from JR Kure Station
- Ferry / Approximately a one minute walk from Kure Chuo Sanbashi



KURE MARITIME MUSEUM  
**YAMATO MUSEUM**



Yamato, the world's greatest battleship ever constructed in Kure, returns.

# Yamato

KURE MARITIME MUSEUM

KURE MARITIME MUSEUM  
**YAMATO MUSEUM**



Battleship Yamato in an official trial off the coast of Sukumo, Kochi on October 30, 1941

Battleship Yamato undergoing final outfitting on September 20, 1941

Yamato at Hashira-jima Hakuchi (inferred) Summer of 1942

Main turret No.1 and No.2 under construction as viewed from the enclosed bridge on June 3,1940



**Observation Terrace [4th Floor]**

You command a panoramic view of the dock where the Battleship Yamato was built, and the ferries traversing Kure Bay.

**4F**

**Conference Room, Training Room, Citizen's Gallery [4th Floor]**

The Museum offers rental space for conferences, training seminars and exhibitions of art and photographs. Please contact us for more information.

**Library [4th Floor]**

Search and see materials on ships and history. You can also look at photos and drawings, and interpretive video in the exhibition rooms on the 1st floor by database search on a PC.

**Submarine Observation Terrace [3rd Floor]**

See an actual submarine.

**3F**

**KURE MARITIME MUSEUM  
YAMATO MUSEUM**

**History of Kure [1st Floor]**

The first exhibition room convey the modernization of the Kure City. After establishment of Kure Chinjufu (Imperial navy base) in 1889 and Kure naval arsenal in 1903, Kure flourished as the greatest naval port city in the East. This room also introduces wartime civilian life and circumstances of Kure air raid. The second room details plans for building the Battleship Yamato, the technology, the fate which Yamato faced and the last testaments and words left behind by Yamato crew members who sailed as a special attack unit on a suicide mission bound for Okinawa. And the history of Kure from postwar reconstruction as a peace industry harbor city to the present date as a worldwide shipbuilding city is on display in the last room.



**1F**



**Yamato Hiroba [1st Floor]**

One-tenth scale model of the Battleship Yamato measuring 26.3 meters in length has been reconstructed to resemble as closely as possible the actual ship based on designs, photographs and underwater imagery through submersible research exploration. With this model of the Battleship Yamato as a symbol of Yamato Museum, we hand down for posterity the importance of peace and the splendor of science and technology.

**Large Objects Exhibition Room [1st Floor]**

Authentic highly valued items such as a Zero fighter, a Kaiten human torpedo and torpedos are displayed.



**Museum Shop Yamato [1st Floor]**

The shop is well-stocked with Yamato-related souvenirs.

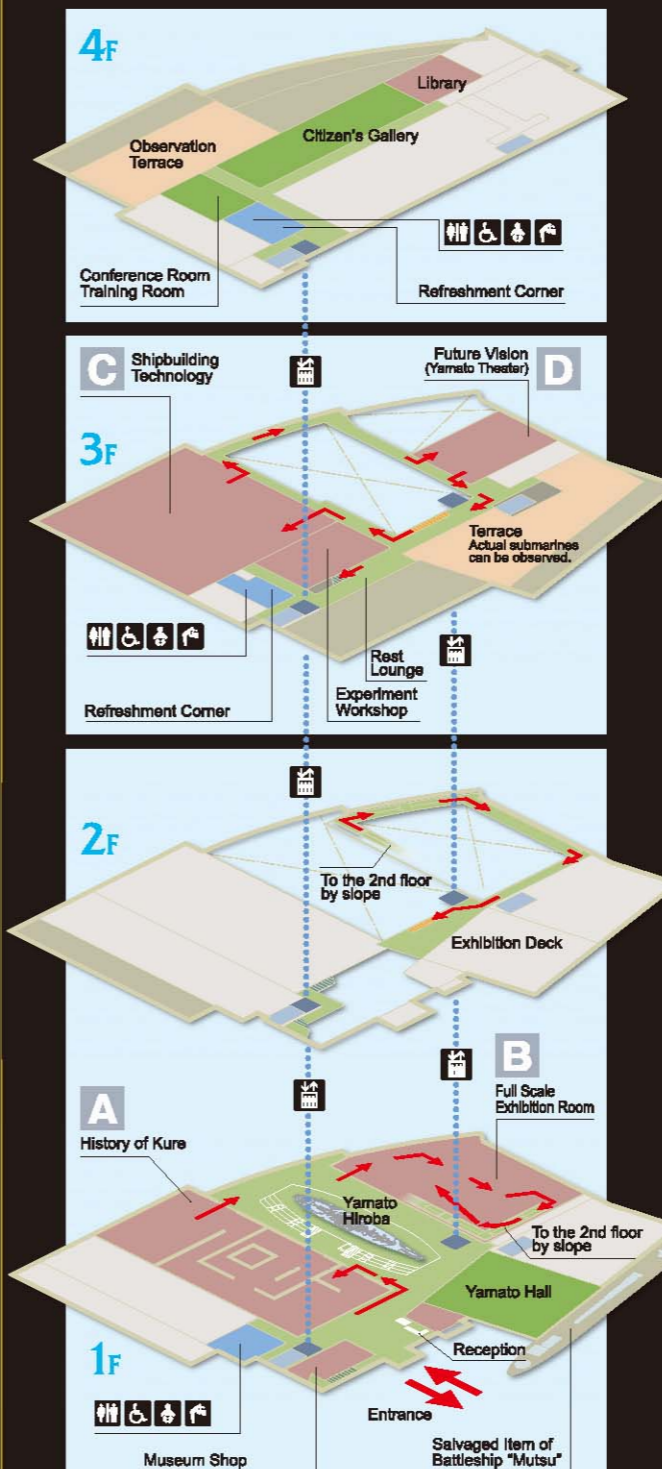

**Shipbuilding Technology [3rd Floor]**

With the ship at the center, this room introduces some principles of science and technology through hands-on learning. Enjoy learning about science. Use a ship handling simulator and a test tank for ships you build. Science shows are held where participants can experience fascinating facts from the world of science. A handicrafts class is also offered.



Yamato Theater



Messages to future generations

**Future Prospects [3rd Floor]**

Here we explore the potential of science and technology relating to the earth and the universe, while featuring messages to future generations from the museum's honorary director and others. The Yamato theater features a set of library shots from JAXA's collection as well as the construction process of the battleship Yamato created by new CG technology.

**Outdoor Exhibition, Grass Area, Yamato Wharf**

Shinkai Research Submarine can be found on the seaside area. Yamato Wharf introduces you to the full-scale length of the battleship "Yamato."



Battleship Mutsu's main gun



Shinkai Research Submarine



Yamato Wharf